

| PLANILLA PORTICOS Y CERCHAS | | | | | | |
|--|---------------|---------------|----------------------------|------------------|-------------|--|
| MARCA | L [m] | CANT. | L TOTAL [m] | DESCRIPCIÓN | OBSERVACIÓN | |
| S50x50x3xL | 708.099 | 1 | 708.10 | TC 50x50x3 | | |
| S100x100x3xL | 1206.687 | 1 | 1206.69 | TC 100x100x3 | | |
| S100x100x5xL | 11.484 | 1 | 11.48 | TC 100x100x5 | | |
| S150x150x5xL | 176.148 | 1 | 176.15 | 2G 150x75x25x5 | | |
| S150x150x8xL | 22.988 | 1 | 22.99 | CAJA 150x150x8x8 | | |
| TSVarxL | 3.200 | 1 | 3.20 | CAJA SEC. VAR. | | |
| S200x200x5xL | 46.040 | 1 | 46.04 | CAJA 200x200x5x5 | | |
| RESUMEN DE PLANILLA PORTICOS Y CERCHAS | | | | | | |
| DESCRIPCIÓN | L TOTAL [m] | PESO [kg/m] | PESO TOTAL AC. A-36 [kg] | | | |
| TC 50x50x3 | 708.10 | 4.48 | 3172.28 | | | |
| TC 100x100x3 | 1206.69 | 9.17 | 11065.32 | | | |
| TC 100x100x5 | 11.48 | 14.40 | 165.37 | | | |
| 2G 150x75x25x5 | 176.15 | 24.90 | 4386.09 | | | |
| CAJA 150x150x8x8 | 22.99 | 35.67 | 819.99 | | | |
| CAJA SEC. VAR. | 3.20 | 15.12 | 48.38 | | | |
| CAJA 200x200x5x5 | 46.04 | 30.62 | 1409.51 | | | |
| TOTAL PESO [kg]: | | | 21066.94 | | | |

*Cantidades no incluye desperdicios

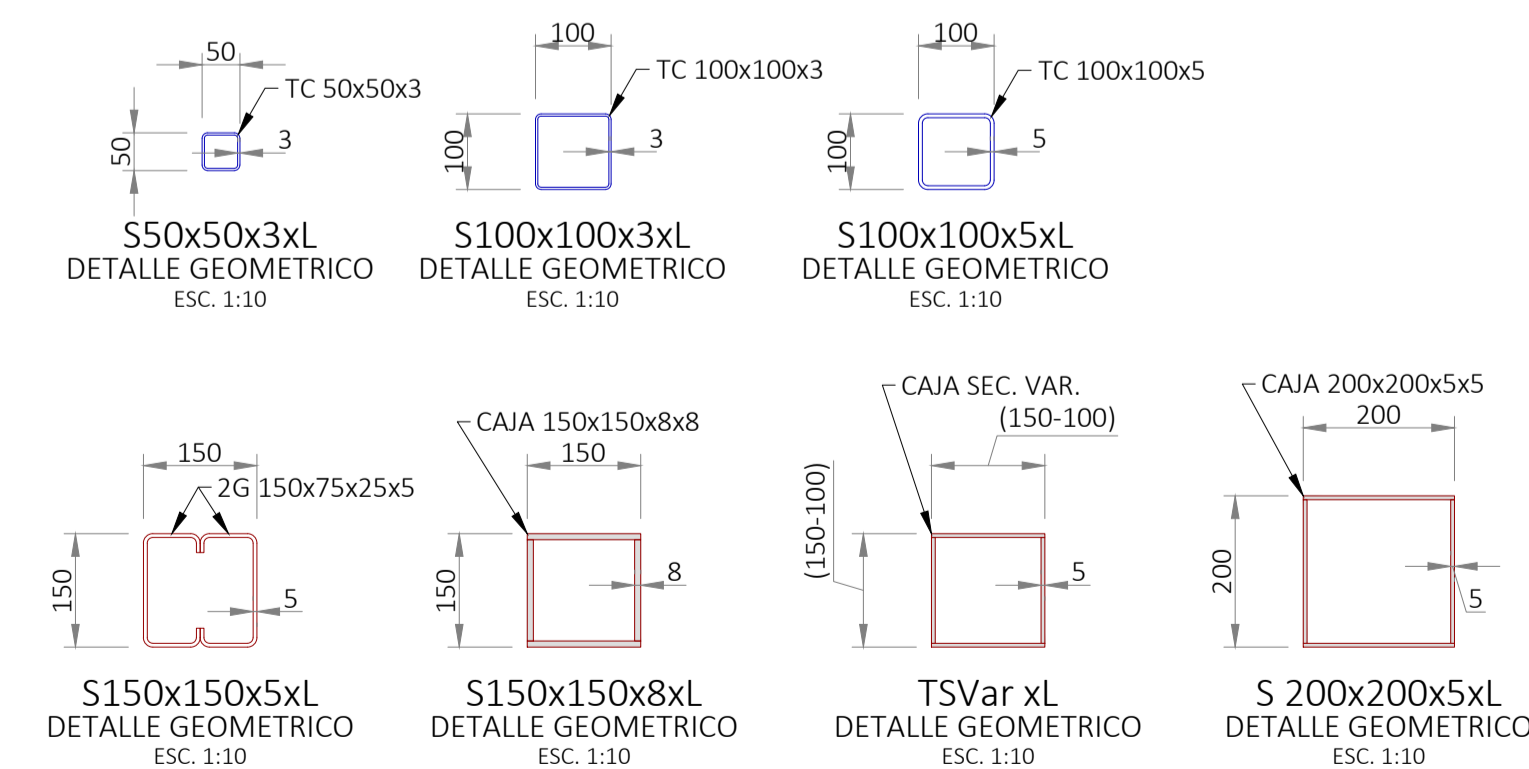
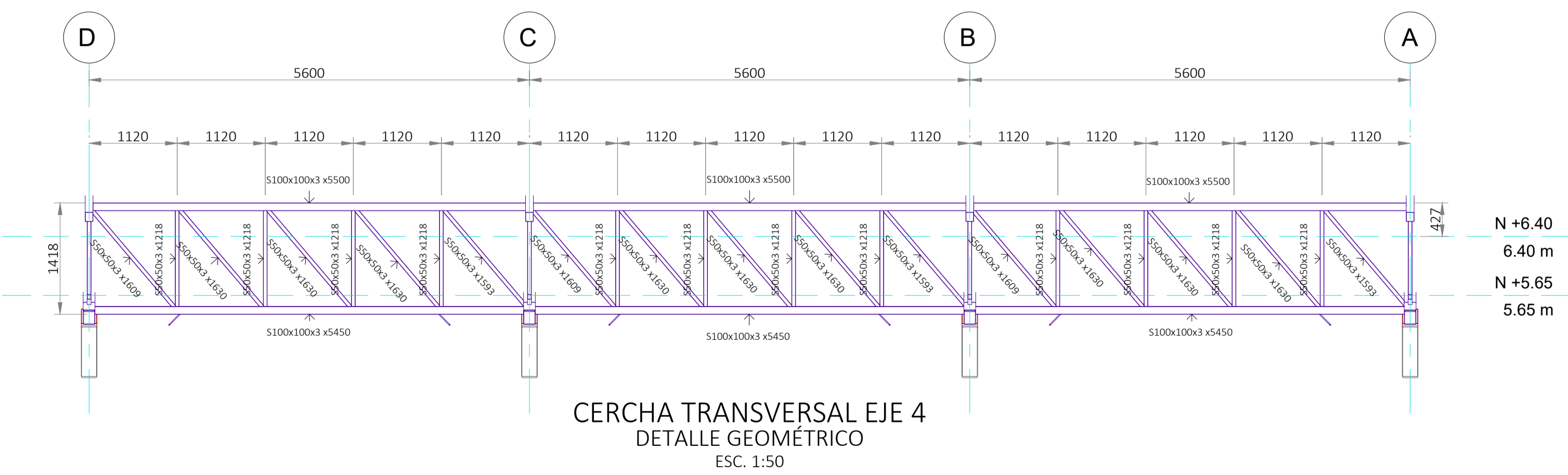
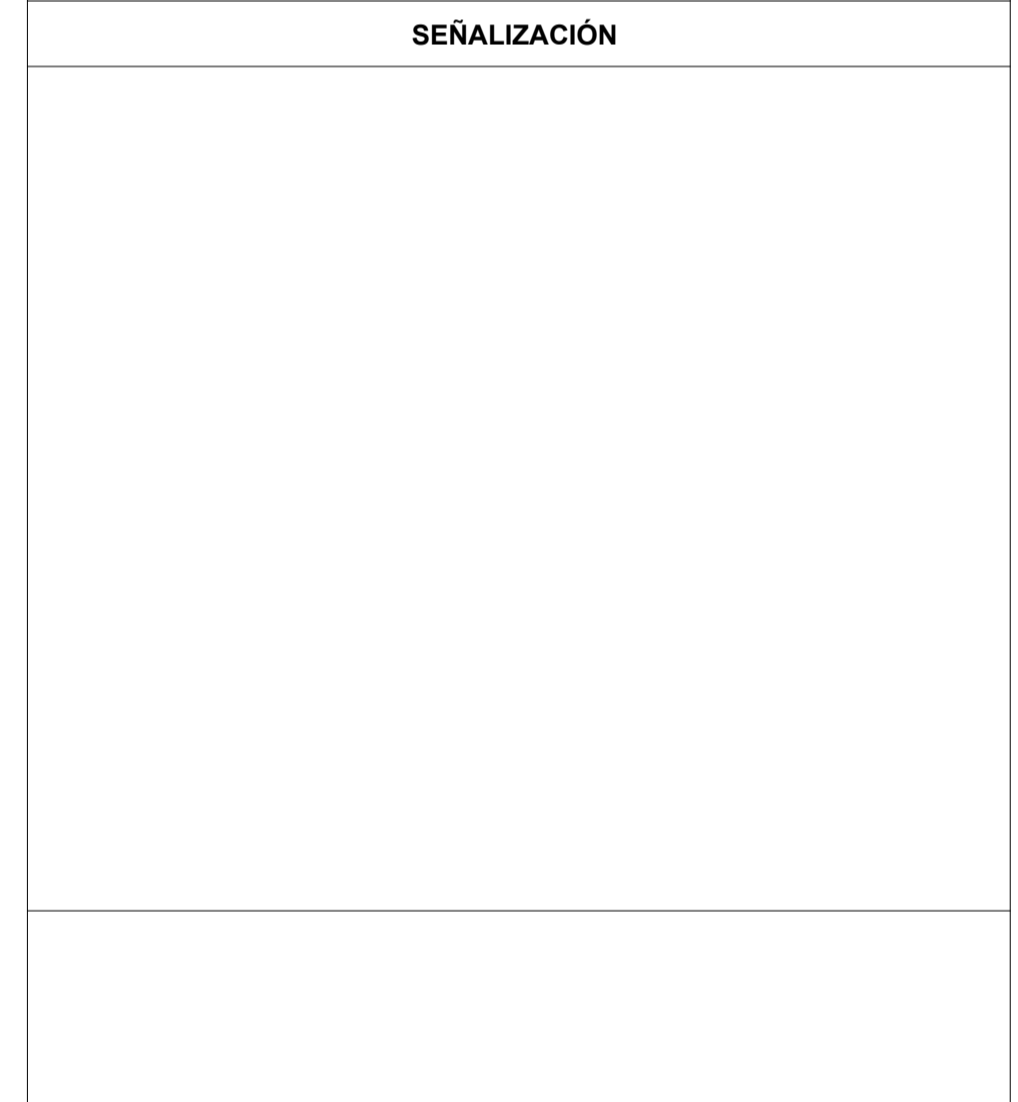

GAD MUNICIPAL DE PABLO SEXTO
DIRECCIÓN DE PLANIFICACIÓN TERRITORIAL E INSTITUCIONAL

PROYECTO: **PARQUE CENTRAL DE PABLO SEXTO**

SELO: _____ CONTENIDO: **ESTRUCTURA ESPACIO CUBIERTO CERCHA
VISTA LATERAL DE CERCHA
DETALLE DE CAJAS
DETALLE DE PLANILLAS
VISTA 3D DE ESTRUCTURA**

DISEÑO ESTRUCTURAL: _____ APROBACIÓN: _____ COORDINACIÓN: _____

ING. FRANCIS GUAYARA BUESTAN
TECNICO DE INFRAESTRUCTURA Y SERVICIOS
BENESCYT 1019-2021-2276912

ING. LEONARDO GALLARDO SAMANEGO
DIRECTOR DE OBRAS PUBLICAS
BENESCYT 1029-2017-1908035

ARG. EDDY SUOLZHARAY ONCE
DIRECTOR DE PLANIFICACIÓN
BENESCYT 1007-14-1276406

ESCALA: LAS INDICADAS FECHA: Octubre - 2022 LAMINA: **ES-008 / A.012**